

***DT SWISS***

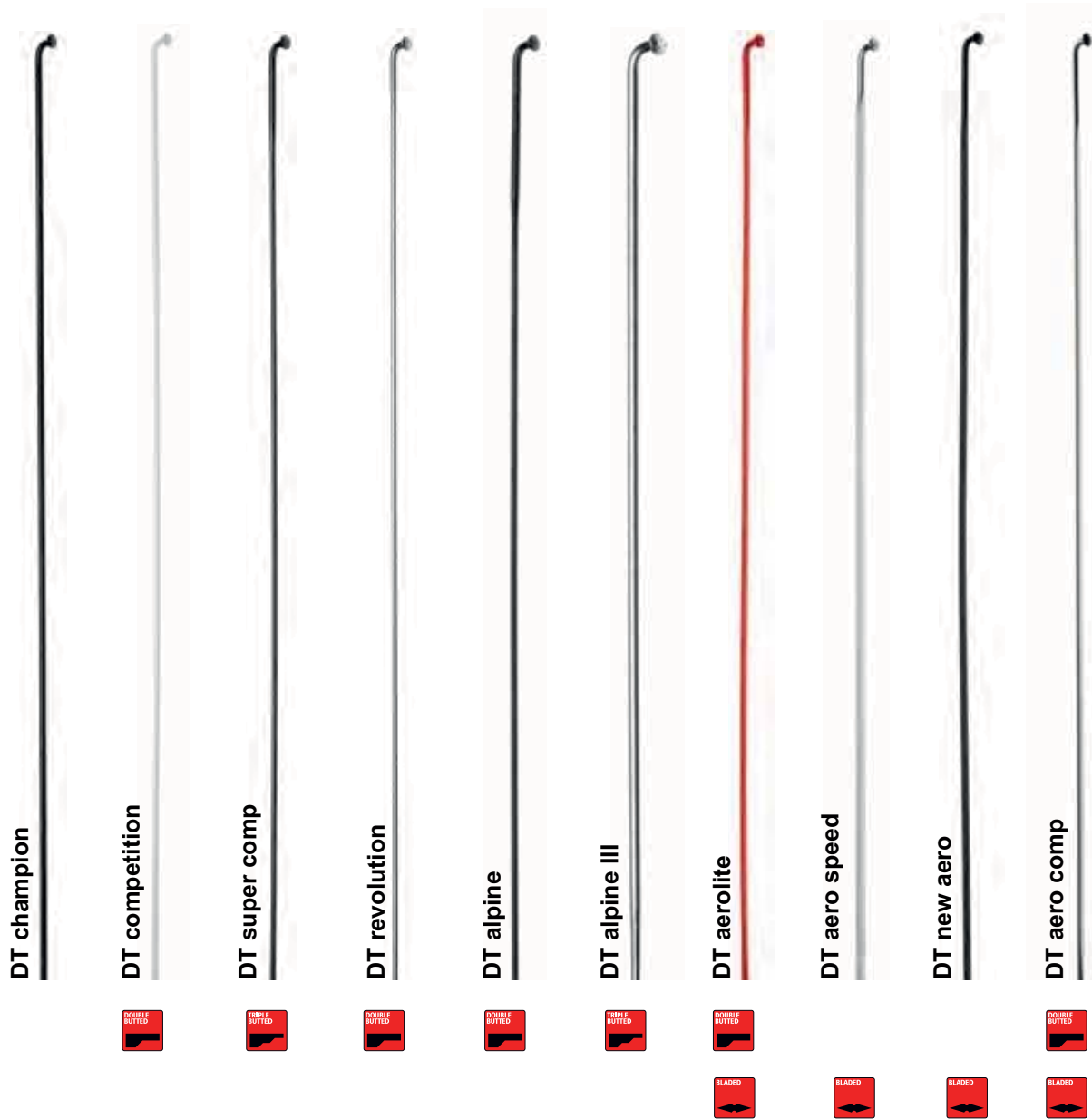

# Szprychy i nypły

Niniejszy katalog obejmuje pełną kolekcję DT Swiss.  
Dostępność produktów w poszczególnych krajach, może się różnić.

# SZPRYCHY

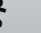

# TECH SPECS

Model	Gwint (DIN 79012)	Długość (L)	Typ	Długość gwintu (G)	Wysokość głowki (H)	Średnica 1 (D1)	Średnica 2 (D2)	Średnica 3 (D3)	Szerokość (B)	Grubość (S)	Kąt głowki (A)	Gauges	Kolor	Waga	
	1.8 mm   FG 2.0 2.0 mm   FG 2.3 2.34 mm   FG 2.6	Range [mm]	 Double butted  Tripple butted  Bladed	9 – 10 mm 6.0 mm 6.2 mm 7.8 mm 1.8 mm 2.0 mm 2.34 mm 1.5 mm 1.6 mm 1.7 mm 1.8 mm 2.0 mm											
DT champion	☼	140 – 315		☼	☼	☼						☼	☼	359	
DT champion		140 – 315		☼	☼	☼						☼	☼	444	
DT champion		140 – 315		☼	☼	☼						☼	☼	591	
DT competition	☼	238 – 300	☼	☼	☼	☼						☼	☼	311	
DT competition		238 – 300	☼	☼	☼	☼	☼					☼	☼	382	
DT super comp	☼	247 – 308	☼	☼	☼	☼						☼	☼	318	
DT revolution		247 – 308	☼	☼	☼	☼	☼					☼	☼	283	
DT alpine		260 – 305	☼	☼	☼	☼		☼				☼	☼	586	
DT alpine III		260 – 305	☼	☼	☼	☼	☼					☼	☼	418	
DT aerolite		238 – 300	☼	☼	☼	☼		☼		☼		☼	☼	278	
DT aero speed	☼	215 – 305		☼	☼	☼		☼		☼		☼	☼	355	
DT new aero		215 – 305		☼	☼	☼		☼		☼		☼	☼	437	
DT aero comp		238 – 300	☼	☼	☼	☼		☼		☼		☼	☼	380	

☼= Serie ●= Option

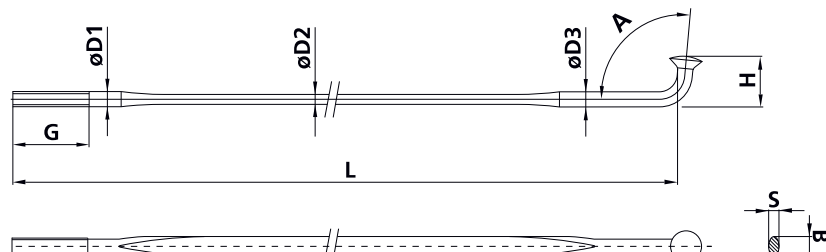

NYPLE



# TECH SPECS

Model	Gwint (DIN 79012)			Długość nypła				Pokrycie gwintu		Kolor							Waga		
	1.8 mm   FG 2.0	2.0 mm   FG 2.3	2.34 mm   FG 2.6	12 mm	14 mm	16 mm	14.5 mm	Bez DT Swiss Pro lock®	DT Swiss Pro flock	Silver	Black	Gold	Green	Blue	Turquoise	Violet	Red	± 5% for 64 nipples [g]	
DT standard brass	⌘			⌘				⌘		⌘	⌘							64	
	⌘				⌘			⌘		⌘	⌘							73	
	⌘					⌘		⌘		⌘	⌘							84	
		⌘		⌘					⌘		⌘	⌘							62
		⌘			⌘				⌘		⌘	⌘							71
			⌘			⌘		⌘	⌘		⌘	⌘							82
DT Pro Lock standard brass			⌘					⌘		⌘	⌘							56	
				⌘				⌘		⌘	⌘							112	
	⌘				⌘				⌘		⌘							64	
	⌘					⌘			⌘		⌘							73	
		⌘					⌘		⌘		⌘							84	
DT standard aluminium								⌘		⌘	⌘	⌘	⌘	⌘	⌘	⌘	⌘	21	
								⌘		⌘	⌘	⌘	⌘	⌘	⌘	⌘	⌘	24	
								⌘		⌘	⌘	⌘	⌘	⌘	⌘	⌘	⌘	27	
		⌘						⌘		⌘	⌘	⌘	⌘	⌘	⌘	⌘	⌘	20	
		⌘						⌘		⌘	⌘	⌘	⌘	⌘	⌘	⌘	⌘	23	
DT Pro Lock standard aluminium																		26	
	⌘				⌘				⌘		⌘							21	
	⌘					⌘			⌘		⌘							24	
		⌘					⌘		⌘		⌘							27	
		⌘					⌘		⌘		⌘							20	
DT pro head brass																		23	
																		26	
	⌘				⌘			⌘		⌘	⌘							61	
	⌘					⌘		⌘		⌘	⌘							70	
		⌘						⌘		⌘	⌘							59	
DT hexagonal brass			⌘		⌘			⌘		⌘	⌘							68	
								⌘		⌘	⌘							74	
		⌘						⌘		⌘	⌘							62	
		⌘						⌘		⌘	⌘						⌘	27	
DT hidden aluminium		⌘		⌘			⌘	⌘	⌘									22	

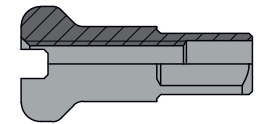

DT standard aluminium  
DT standard brass

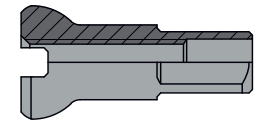

DT pro head brass

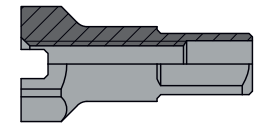

DT hexagonal brass

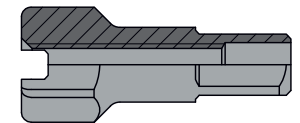

DT hexagonal aluminium

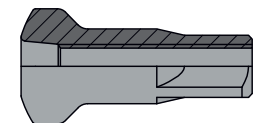

DT hidden aluminium

⌘ = Serie   ● = Option